

**DEVELOP**

**DOKU PARTNER**  
BEDST PÅ PRINT, SCAN & KOPIMASKINER

Dynamic balance

[www.develop.eu](http://www.develop.eu)



# ineo 3602P



- > Black & white A4 printer
- > Up to 36 ppm

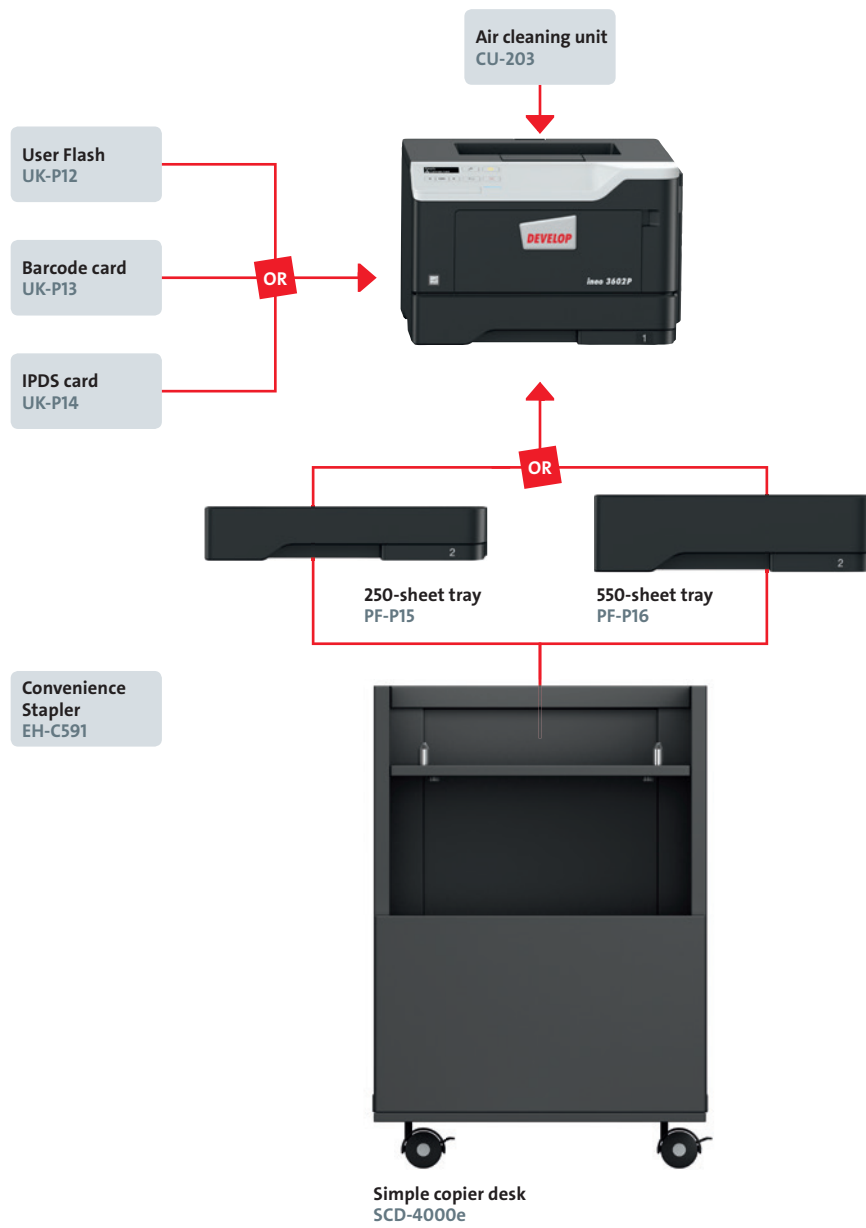

## Finishing functionalities



Duplex



Corner  
stapling  
(off-line)

## Description

## ineo 3602P

Laser printer with 36 ppm b/w. Standard Gigabit Ethernet, 512 MB memory, duplex unit, PCL 5/6, PostScript 3 and XPS support. Paper capacity of 250 sheets and 100-sheet manual bypass. Media from A6 to A4 and 60 – 216 g/m<sup>2</sup>.

PF-P15 Paper tray	A5–A4, 250 sheets, 60–120 g/m <sup>2</sup>
PF-P16 Paper tray	A5–A4, 550 sheets, 60–120 g/m <sup>2</sup>
SCD-4000e Copier desk	Ensures ergonomic height and provides storage space for print media, etc.

UK-P12 User flash	256 MB User flash for storing fonts, forms and macros or to save job account log
UK-P13 Barcode card	Printer-based electronic barcode engine
UK-P14 IPDS card	Provides compatibility for IPDS printing
CU-203 Air cleaning unit	Improving indoor air quality by reduced emissions
EH-C591 Convenience stapler	Convenient stapling of up to 50 prints per set

## Technical specifications

## SYSTEM SPECIFICATIONS

Panel size/resolution	2 line LCD / 128 x 32
System memory	512 MB (standard)
Interface	10-Base-T/100-Base-TX/1,000-Base-T Ethernet; USB 2.0; Wi-Fi 802.11b/g/n
Network protocols	TCP/IP (IPv4 / IPv6); AppleTalk; Bonjour; SMB; LPD; IPP; SNMP; HTTP/S
Printable paper size	A6–A4, customised paper sizes
Printable paper weight	60–216 g/m <sup>2</sup>
Paper input capacity	Standard: 350 sheets; Max.: 900 sheets
Paper tray input (standard)	250 sheets, A6–A4, 60–120 g/m <sup>2</sup>
Paper tray input (optional)	250/550 sheets; A5–A4; 60–120 g/m <sup>2</sup>
Manual bypass	100 sheets, A6–A4, custom sizes, 60–216 g/m <sup>2</sup>
Automatic duplexing	A4; 60–90 g/m <sup>2</sup>
Output capacity	Max.: 150 sheets
Print volume (monthly)	Rec.: 3,600 pages Max. <sup>1</sup> : 50,000 pages
Toner lifetime	Up to 15,000 pages
Imaging unit lifetime	Up to 60,000 pages
Power consumption	220–240 V / 50/60 Hz; Less than 520 W
System dimensions (W x D x H)	399 x 374 x 260 mm
System weight	Approx. 14 kg

## PRINTER SPECIFICATIONS

Printing process	Electrostatic laser
Print speed A4	Up to 36 ppm
Autoduplex speed A4	Up to 19 ppm
1st print out time	6.5 sec.
Print resolution	1200 x 1200 dpi
Page description language	PCL 5/6; PostScript 3; XPS
Operating systems	Windows 7 (32/64); Windows 8/8.1 (32/64); Windows 10 (32/64); Windows Server 2008 (32/64); Windows Server 2008 R2; Windows Server 2012; Windows Server 2012 R2; Windows Server 2016; Macintosh OS X 10.9 or later; Linux
Printer fonts	89 PCL Latin; 158 PostScript 3 Emulation Latin
Print functions	Duplex, n-up, watermark, electronic sorting
Mobile Printing	AirPrint (iOS), Mopria (Android), Google Cloud Print, ineoPRINT (iOS/Android/Windows 10 Mobile), Wifi Direct

## SYSTEM FEATURES

Security	TCP/UDP port disabling; certificate management; SNMPv3; IPsec support; HTTPS; IP filtering and port blocking; IEEE 802.1x support; SMTP authentication
Software	Device Manager (opt.)

<sup>1</sup> If the maximum volume is reached within a period of one year, then a maintenance cycle must be performed

**Cartridge Return Program**

DEVELOP Return Program cartridges are patented print cartridges sold at a discount in exchange for the customer's agreement to the license requirement that the cartridges will be used only once and returned only to manufacturer for remanufacturing or recycling. These patented cartridges are licensed for single use only and will stop working after delivering a fixed amount of toner. Toner may remain in the cartridge when replacement is required.

Replacement cartridges sold without these restrictions (non-returnable cartridges) are also available. Please contact a DEVELOP representative for further details and availability.



**DEVELOP**

Konica Minolta Business Solutions Europe GmbH  
 Europaallee 17 30855 Langenhagen Germany Phone +49 511 7404-0 www.develop.eu

**DOKU PARTNER**  
 BEDST PÅ PRINT, SCAN & KOPIMASKINER

Parkboulevarden 31 (+45) 71 99 97 72  
 8920 Randers NV info@dokupartner.dk

For more information regarding the ineo 3602P please refer to the respective product homepage



- All specifications refer to A4-size paper of 80 g/m<sup>2</sup> quality.
- The support and availability of the listed specifications and functionalities varies depending on operating systems, applications and network protocols as well as network and system configurations.
- The stated life expectancy of each consumable is based on specific operating conditions such as page coverage for a particular page size (5% coverage of A4). The actual life of each consumable will vary depending on use and other printing variables including page coverage, page size, media type, continuous or intermittent printing, ambient temperature and humidity.
- Specifications and accessories are based on the information available at the time of printing and are subject to change without notice.
- DEVELOP and ineo are registered trademarks/product titles owned by Konica Minolta Business Solutions Europe GmbH.
- Konica Minolta does not warrant that any specifications mentioned will be error-free.
- All brand and product names may be registered trademarks or trademarks of their respective holders and are hereby acknowledged.